



# 3D衬纬鞋面机

## WEFT-INSERTION SHOE UPPER MACHINE

KSC092D/093D/132D/133D 高效5.2英寸小机头  
Efficient 5.2-inch small carriage





## KSC092D/093D/132D/133D

5.2英寸小机头衬纬鞋面机，支持编织绝大部分常规的鞋面织物，并配置可调紧吊目功能，根据编织物的不同需求，可在系统内调节沉降片工作的有效参数，衬纬纱嘴单把单吹填充的纱线容量可达8000D左右，轻松实现厚实鞋面织物的编织需求。

5.2-inch mini carriage weft-insertion shoe upper knitting machine, supports most conventional shoe upper fabrics and is equipped with adjustable tight tuck function. According to the different requirements of knitted fabrics, the effective parameters of sinker can be adjusted in the system. The yarn capacity of weft insertion by single yarn feeder can reach about 8000D, which can easily realize thick and solid shoe upper knitting requirements of fabrics.







采用LED触摸屏，操控更便捷、更简单  
With LED touchscreen, more easily and convenient to operate.

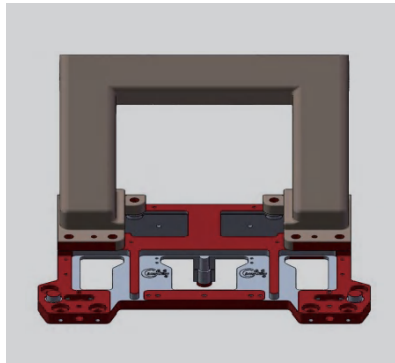

缩小机头尺寸，减轻机头重量减少运动惯性，以加快回转速度

Reduce the size and weight of the carriage and make the return speed faster.



采用高性能伺服控制技术，机头运行行程更加精准，换向更快

High-performance servo control technology, the machine's running position is more accurate, and the return is faster.

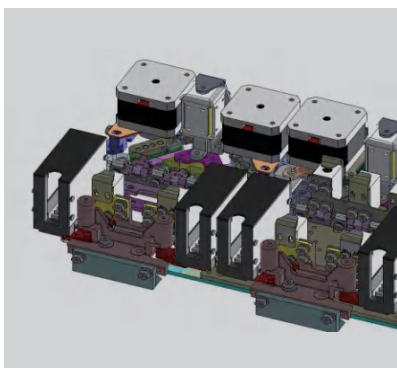

可调吊目装置，可充分满足鞋面松、紧吊目组织的特殊需求，推针三角独立控制机构，缩短机头换向时间

Adjustable tight tuck device can fully meet the special needs of the loose or tight tuck organization of the shoe upper, independent pushing needle cam control mechanism, shorten the carriage return time.



交叉式沉降片设计，由系统控制压纱深浅，适合较厚实的填充织物和护膝、手套等特殊织物的编织

Cross-type sinker design, controlled by the system, the depth of the yarn is suitable for the knitting of thick fabrics and special fabrics such as knee pads and gloves.

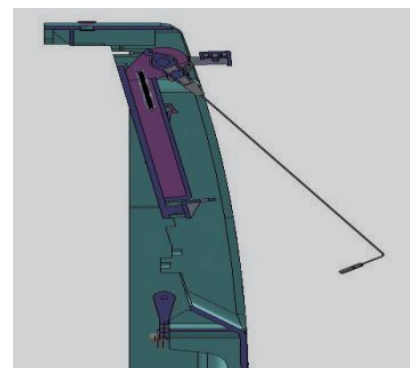

提供持续稳定的送纱张力配备无极张力调节和非接触式电子感应报警装置

Provides consistent and stable yarn feed tension with stepless tension adjustment and non-contact electronic induction alarm.

## 产品参数

| Model<br>机器型号  | KSC092D   | KSC093D  | KSC132D  | KSC133D  |
|--|---|----------|----------|----------|
| Basic parameters<br>基础参数                                     | ● Standard configuration      ○ Optional      — Without |          |          |          |
| Gauge<br>针型  | 12G/14G/16G/18G   |          |          |          |
| Carriage<br>机头数量   | 1   | 1        | 1        | 1        |
| Knitting system<br>编织系统                                      | 2 SYSTEM  | 3 SYSTEM | 2 SYSTEM | 3 SYSTEM |
| Width (INCH)<br>宽度 (英寸)                                      | 36  | 36       | 52       | 52       |
| Inset needle bed<br>插片针板                                     | ●   | ●        | ●        | ●        |
| Running speed (M/S)<br>运转速度 (米/秒)                            | 1.4   | 1.4      | 1.4      | 1.4      |
| SMALL Carriage<br>小机头  | ●   | ●        | ●        | ●        |
| Probe<br>探针  | Infrared  | Infrared | Infrared | Infrared |
| Motor transfer<br>马达翻针                                       | ●   | ●        | ●        | ●        |
| Machine two side tool box<br>两边工具箱                           | ○   | ○        | ○        | ○        |
| Cleaning system<br>清洁系统                                      | —   | —        | —        | —        |
| Motor driving selection<br>JACK raise cam<br>马达换向            | ●   | ●        | ●        | ●        |
| Needle bed racking<br>针板摇床                                   | ±1inch  | ±1inch   | ±1inch   | ±1inch   |
| Sinker<br>信克   | ●   | ●        | ●        | ●        |
| Lubrication system<br>(auto, manual, none)<br>润滑系统 (自动、手动、无) | Auto  | Auto     | Auto     | Auto     |
| Tight tuck<br>紧吊目  | ●   | ●        | ●        | ●        |
| Dynamic density<br>可变量目                                      | ●   | ●        | ●        | ●        |

| Model<br>机器型号   | KSC092D                  | KSC093D     | KSC132D     | KSC133D     |
|---|--------------------------|-------------|-------------|-------------|
| Take down device<br>牵拉系统  | ● Standard configuration |             | ○ Optional  | — Without   |
| Rubber roller<br>皮罗拉  | ●                        | ●           | ●           | ●           |
| Auto down roller<br>自动开合下罗拉                                     | —                        | —           | —           | —           |
| Manual down roller<br>手动开合下罗拉                                   | ○                        | ○           | ○           | ○           |
| Comb<br>起底板   | —                        | —           | —           | —           |
| Wire comb<br>无废纱起底  | —                        | —           | —           | —           |
| Scissors<br>剪刀夹子  | —                        | —           | —           | —           |
| Yarn device<br>喂纱装置   | ● Standard configuration |             | ○ Optional  | — Without   |
| Top tension<br>天线台数量  | 16 PCS                   | 16 PCS      | 16 PCS      | 16 PCS      |
| Lycra feeder<br>氨纶送纱器   | ●                        | ●           | ●           | ●           |
| Yarn storage device<br>储纱器                                      | —                        | —           | —           | —           |
| Yarn supplier device<br>送纱器                                     | ●                        | ●           | ●           | ●           |
| Yarn carrier<br>纱嘴  | ● Standard configuration |             | ○ Optional  | — Without   |
| Carrier quantity<br>纱嘴数量  | 16 PCS                   | 16 PCS      | 16 PCS      | 16 PCS      |
| Auto motor-driven carrier<br>智跑纱嘴                               | ○ Max 8 pcs              | ○ Max 8 pcs | ○ Max 8 pcs | ○ Max 8 pcs |
| Up-and-down motion carrier<br>自动上下纱嘴                            | ○ Max 8 pcs              | ○ Max 8 pcs | ○ Max 8 pcs | ○ Max 8 pcs |
| Weft insetion carrier<br>衬纬纱嘴                                   | ○                        | ○           | ○           | ○           |
| Ultra-wide adjustable carrier<br>(34-47mm)<br>超宽可调节纱嘴 (34-47毫米) | ○                        | ○           | ○           | ○           |
| Double holes<br>双孔纱嘴  | ○                        | ○           | ○           | ○           |

| Model<br>机器型号  | KSC092D                  | KSC093D | KSC132D    | KSC133D   |
|--|--------------------------|---------|------------|-----------|
| Safty device<br>安全装置                                     | ● Standard configuration |         | ○ Optional | — Without |
| Emergency stop devices<br>紧急停车装置                         | ●                        | ●       | ●          | ●         |
| Safty cover with infrared ray<br>护罩红外感应                  | ●                        | ●       | ●          | ●         |
| Power cut off device<br>断电记忆                             | ●                        | ●       | ●          | ●         |
| Alarm device<br>报警装置                                     | ● Standard configuration |         | ○ Optional | — Without |
| Fabric rewind alarm<br>(infrared ray)<br>布片倒卷报警 (红外线)    | ●                        | ●       | ●          | ●         |
| Fabric rewind alarm<br>(detection board)<br>布片倒卷报警 (倒卷板) | —                        | —       | —          | —         |
| Needle crash alarm<br>撞针报警                               | ●                        | ●       | ●          | ●         |
| Yarn breakage alarm<br>断纱报警                              | ●                        | ●       | ●          | ●         |
| Yarn knot alarm<br>纱结报警                                  | ●                        | ●       | ●          | ●         |
| Stroke protection device<br>(racking)<br>摇床限位报警          | ●                        | ●       | ●          | ●         |
| Stroke protection device<br>(carriage)<br>机头限位报警         | ●                        | ●       | ●          | ●         |
| Over load alarm<br>过载报警                                  | ●                        | ●       | ●          | ●         |
| Knit piece finish alarm<br>编织件数完成报警                      | ●                        | ●       | ●          | ●         |
| Sepecific row stop<br>指定行停车                              | ●                        | ●       | ●          | ●         |
| Program error<br>程序错误                                    | ●                        | ●       | ●          | ●         |
| Power<br>电源  | ● Standard configuration |         | ○ Optional | — Without |
| AC 220V ± 5%(1phase 50/60Hz)<br>单相220V、50/60HZ           | ●                        | ●       | ●          | ●         |
| AC 380V ± 5%(3phase 50/60Hz)<br>三相380V、50/60HZ           | ○                        | ○       | ○          | ○         |
| Power consumption<br>功率                                  | 1.5KW                    | 2.0KW   | 1.5KW      | 2.0KW     |

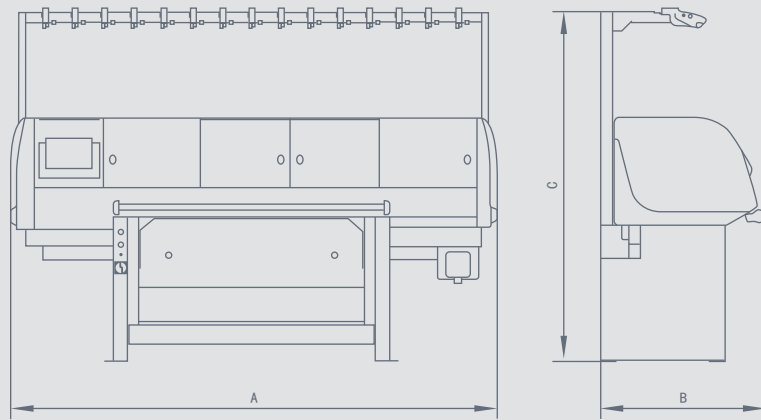

| 机器型号<br>MACHINE MODEL | 外形尺寸(毫米)<br>BOUNDARY DIMENSION(mm)         | 包装尺寸(毫米)<br>PACKAGE DIMENSION(mm) | 净重(kg)<br>NET WEIGHT(KG) | 毛重(kg)<br>GROSS WEIGHT(KG) |
|-----------------------|--|-----------------------------------|--------------------------|----------------------------|
|                       | 长×宽×高(A×B×C)<br>LENGTH×WIDTH×HEIGHT(A×B×C) | 长×宽×高<br>LENGTH×WIDTH×HEIGHT      |                          |                            |
| KSC092                | 2150×865×1850                              | 2300×950×1820                     | 680                      | 830                        |
| KSC093                | 2450×865×1850                              | 2650×1050×1820                    | 720                      | 900                        |
| KSC132                | 2435×815×1850                              | 2650×1050×1820                    | 565                      | 730                        |
| KSC133                | 2435×865×1850                              | 2650×1050×1820                    | 565                      | 730                        |

## 苏州梵洲科技有限公司

SUZHOU FANZHOU TECHNOLOGY CO.,LTD

江苏省常熟市阳光大道8号

No.8 Yanguang Road, Changshu City, Jiangsu, China

电话 T +86-15250337092

传真 F +86-15250337092

邮箱 E Juanschuan@gmail.com

Website: www.fanzhoultd.com

Whatsapp: +86-15250337092



Website



Wechat



Whatsapp